

# Drawing B-1007

## Non-insulated roofing with tile floor

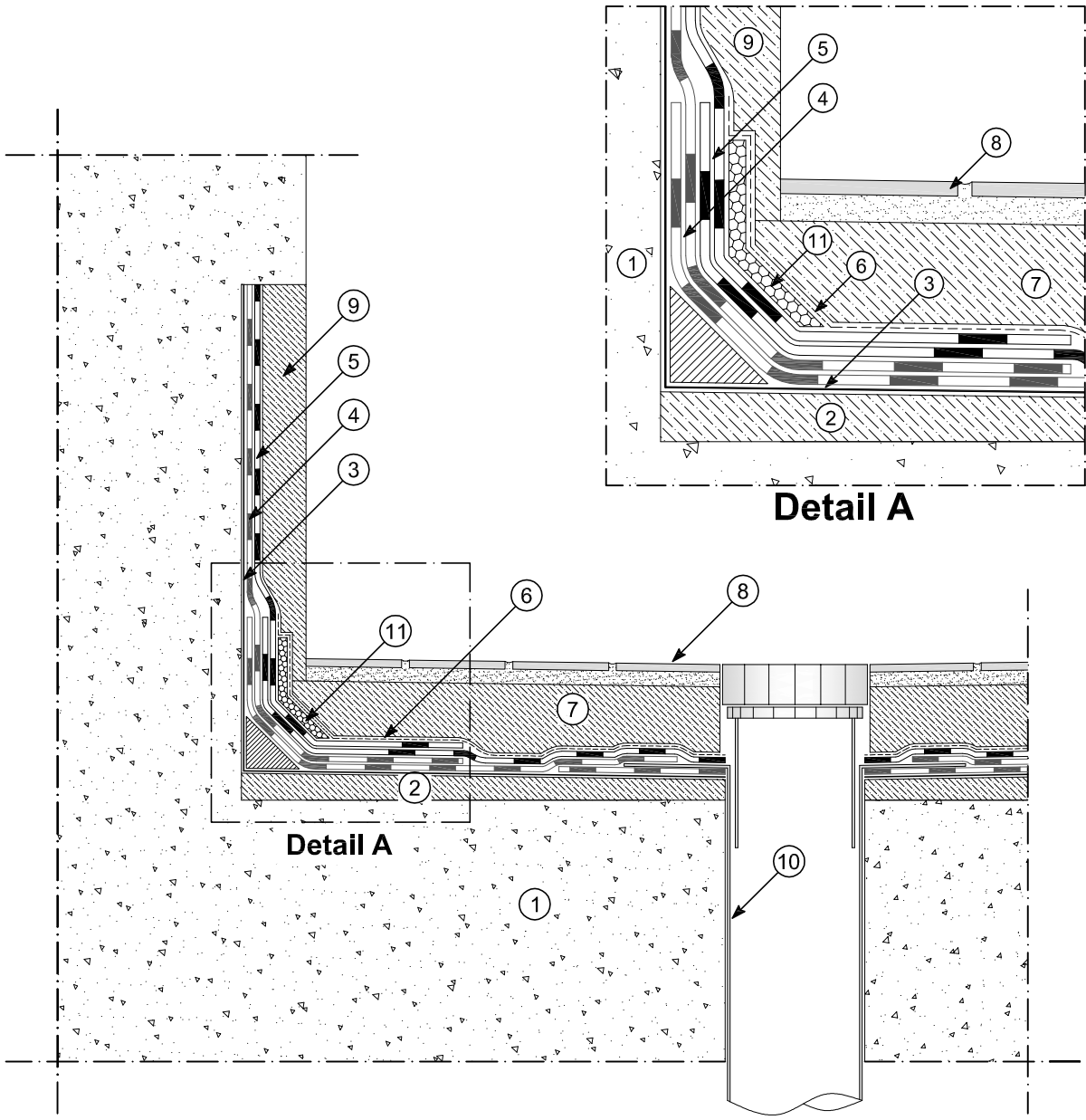

- |  |  |
|--|--|
| ① Structure                              | ⑦ Protective screed                                  |
| ② Concrete gradient screed               | ⑧ Tile floor   |
| ③ Bituminous primer POLYPRIMER HP 45 PRO | ⑨ Vertical turn-up protected with screen and plaster |
| ④ Bituminous membrane (1st layer)        | ⑩ Outlet in 20/10 lead                               |
| ⑤ Bituminous membrane (2nd layer)        | ⑪ Shock absorber                                     |
| ⑥ Double separation layer                |  |

05.03.2012

reproduction prohibited  
without cite the source