

Drawing B-1012

Non-insulated roof garden

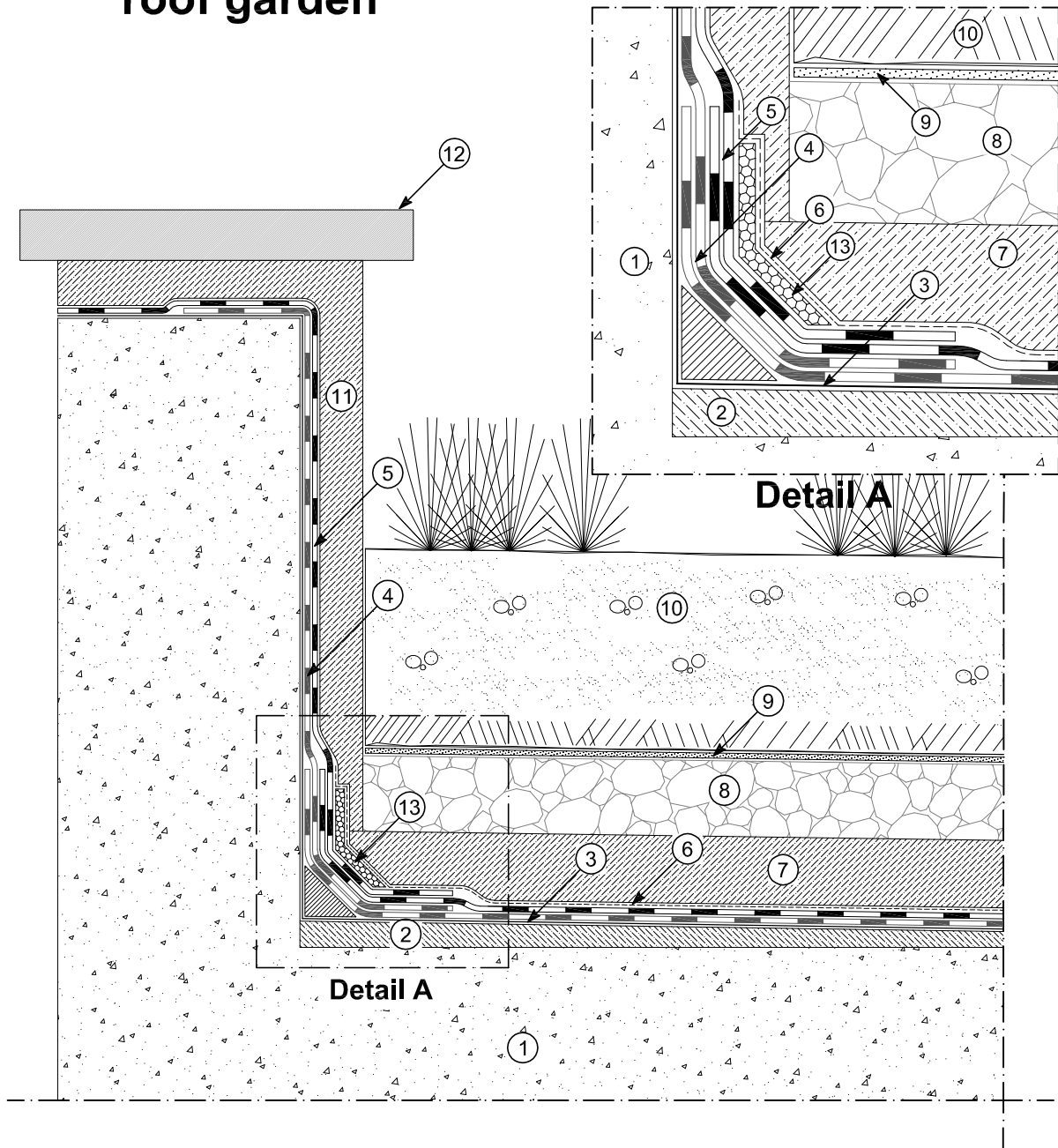

- | | |
|--|--|
| ① Structure | ⑧ Gravel drainage layer |
| ② Concrete gradient screed | ⑨ Non-woven fabric drainage layer |
| ③ Bituminous primer POLYPRIMER HP 45 PRO | ⑩ Soil |
| ④ Bituminous membrane (1st layer) | ⑪ Vertical turn-up protected with screen and plaster |
| ⑤ Bituminous membrane (2nd layer) | ⑫ Finishing element |
| ⑥ Double separation layer | ⑬ Shock absorber |
| ⑦ Protective screed | |

05.03.2012

reproduction prohibited
without cite the source